



MACRON DYNAMICS, INC.

1-800-MACRON-1 (1-800-622-7661)

460 Caredean Drive · Horsham, PA 19044-1325

215-443-8888 Fax 215-443-0981

macron@macrondynamics.com

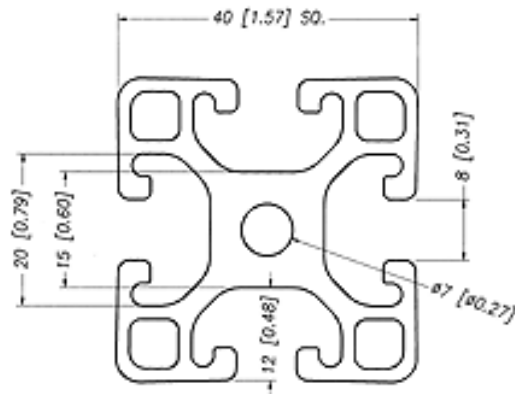
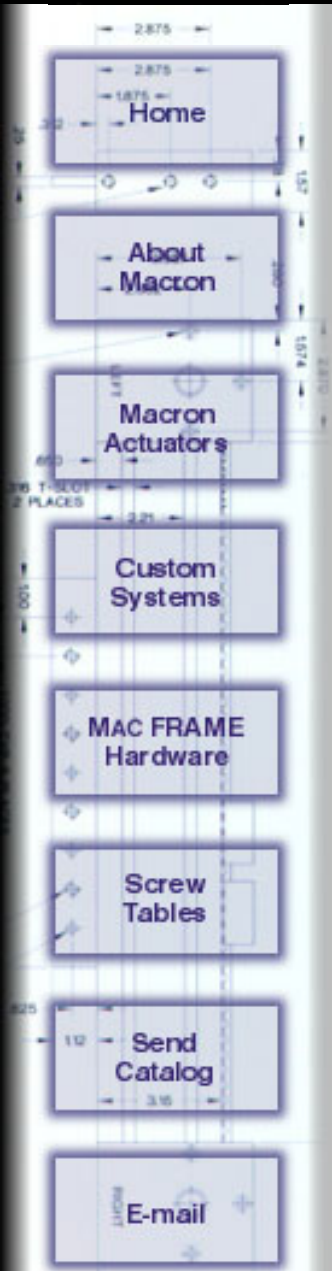

40X40S Aluminum Extrusion

PART NO.	DESCRIPTION
M10040	40X40S Aluminum Extrusion

Maximum Length: 6096mm/ 20 Ft.

Technical Specifications

Material: 6005 - T5 Aluminum

Finish: Clear, Anodized*

I: 9.62cm⁴/.231 in⁴

W: 4.81cm³/.294 in³

Profile Section: 6.48 cm²/ 1.004 in²

Weight: 1.78 kg/m - 1.192 lbs./ft

***Note:** For other finishes, contact factory

**Made In
USA**

MACRON DYNAMICS, INC.

[Site Map](#)



MACRON DYNAMICS, INC.

1-800-MACRON-1 (1-800-622-7661)

460 Caredean Drive · Horsham, PA 19044-1325
 215-443-8888 Fax 215-443-0981
 macron@macrondynamics.com

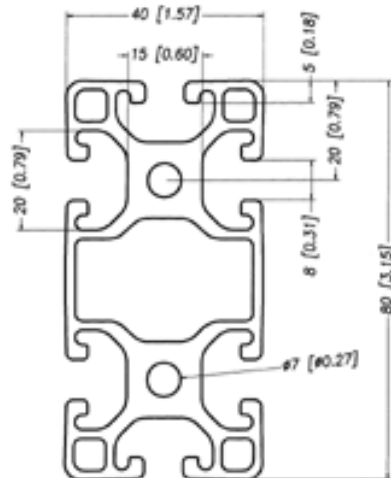
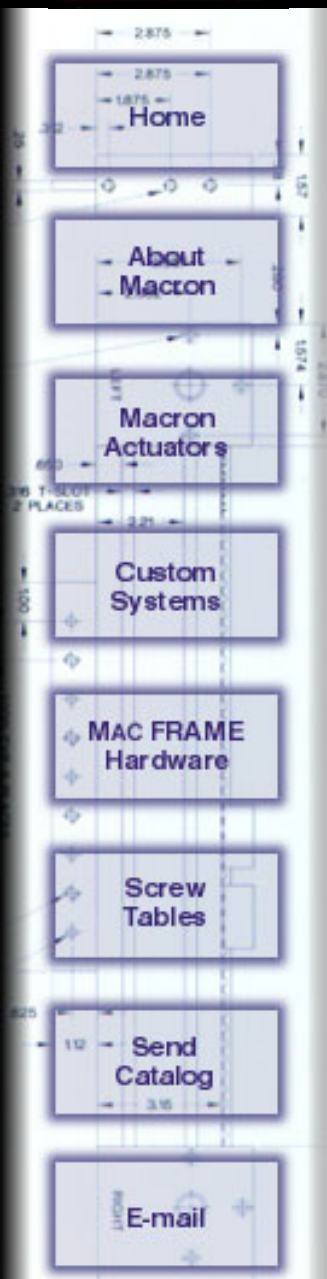

40X80S Aluminum Extrusion

PART NO.	DESCRIPTION
M10080	40X80S Aluminum Extrusion

Maximum Length: 6096mm/ 20 Ft.

Technical Specifications

Material: 6005 - T5 Aluminum

Finish: Clear, Anodized*

I_x: 67.22 cm⁴/1.615 in⁴

I_y: 17.64 cm⁴/.424 in⁴

W_x: 16.80 cm³/1.025 in³

W_y: 8.93 cm³/.545 in³

Profile Section: 11.56 cm²/1.792 in²

Weight: 3.10 kg/m - 2.081 lbs/ft.

***Note:** For other finishes, contact factory

**Made In
USA**

MACRON DYNAMICS, INC.

[Site Map](#)



MACRON DYNAMICS, INC.

1-800-MACRON-1 (1-800-622-7661)

460 Caredean Drive · Horsham, PA 19044-1325

215-443-8888 Fax 215-443-0981

macron@macrondynamics.com

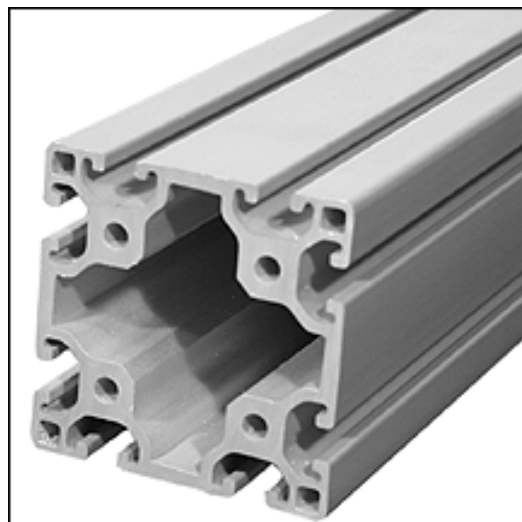

80X80S Aluminum Extrusion

PART NO.	DESCRIPTION
M10088	80X80S Aluminum Extrusion

Maximum Length: 6096mm/ 20 Ft.

Technical Specifications

Material: 6005 - T5 Aluminum

Finish: Clear, Anodized*

I: 127.72 cm⁴/3.068 in⁴

W: 31.93 cm³/1.948 in³

Profile Section: 20.27 cm²/3.142 in²

Weight: 5.28 kg/m - 3.547 lbs./ft.

***Note:** For other finishes, contact factory

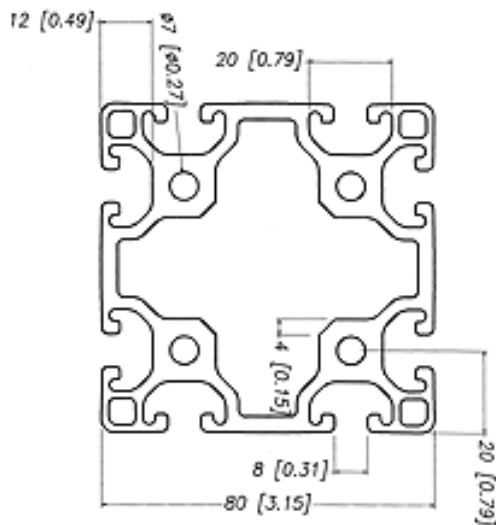

**Made In
USA**

MACRON DYNAMICS, INC.

[Site Map](#)